

A close-up photograph shows a person's hands pulling a white paper napkin from a dispenser. The dispenser is a sleek, metallic, cylindrical unit mounted on a wall of white square tiles. The person is wearing a grey long-sleeved shirt. The background is a clean, bright white tiled wall.

# tesa<sup>®</sup> Power.Kit FOR WASHROOM DISPENSERS

Mounting without Drilling – Removing without Damage



# tesa® Power.Kit

## Heavy-Duty Fixation without Drilling

Washroom dispensers in the professional cleaning and hygiene industry are nowadays typically installed based on drilling/ anchor or mounting-tape technology. This type of installation technology is very time-consuming, noisy, and makes cleaning of dust and dirt necessary after installation. In addition, drilling as an installation method brings with it the risk that tiles, surfaces, or even electrical cables are damaged during installation, leading to the need for costly and time-consuming repairs afterwards.

The innovative tesa® Power.Kit system in contrast offers a quick and clean way of installing washroom dispensers without the need for drilling. The advantages are clear: no need to spend additional time on cleaning or repairing after installation and reduced installation times thanks to fast and efficient mounting with the easy-to-use tesa® Power.Kit adapter.

### Advantages and benefits

tesa® Power.Kit offers innovative mounting technology for washroom dispensers that works on a wide range of surfaces without the need for drilling.

When there is a need for replacement, the tesa® Power.Kit can be removed without damage to the original surface which the dispenser was installed on.

## Mounting of Washroom Dispensers



### Dispensers for soap and towels

In the professional cleaning and hygiene industry, paper or fabric towels, as well as liquid cleaning and disinfection products, are regularly dispensed using manual or automatic dispensers. These dispensers are typically mounted in an environment and on surfaces that are cleaned and disinfected multiple times per day.

It is the nature of this heavy-duty application that dispensers regularly need to be serviced or replaced. In addition, if new models are available or suppliers are switched, most of the time the assembly plates have a different kind of geometry and/or spacing, making it difficult to reuse existing drilling holes.

Having a mounting system which does not rely on conventional fasteners and which can be used without the need for destructive drilling into delicate surfaces like tiles, metal, or glass brings a clear benefit for installers, facility managers, and cleaning staff.

#### Advantages:

- No noise, dirt, or dust during installation
- No drilling holes
- No damage to surfaces and electrical cables



#### Suitable surfaces

- Tiles
- Marble
- Natural stone
- Glass
- Concrete
- Wood
- Metal



#### Unsuitable surfaces

- Coating
- Wallpaper
- Plaster
- PE/Teflon/PP



## tesa® Power.Kit Assortment

tesa® Power.Kit (incl. tesa® ACX <sup>plus</sup> Die Cut)	Male		Female		Female (cut)	Assembly ring
	M4	M6	M4	M6	M4	
<b>Super Light Duty</b> 4 kg	● A481				■ A01	● A44
<b>Light Duty</b> 5 kg	● A37 ● A581 ● A771 ● A34				● A56 ● A72	● A02
<b>Normal Duty</b> 6 kg		● A22 ● A681	● A151	● A601		
<b>Heavy Duty</b> 15 kg		● A97 ● A98		● A08		
<b>Super Heavy Duty</b> 20 kg		■ A14				
<b>Glue</b> 4 g	Glue (G1)					

### tesa® Power.Kit system components



The adapter consists of a sintered metal plate with copper, the rest being made of tin and wax. The metal plate is permeable for air, allowing a shorter drying time. Furthermore the adhesive ring provides a border for the glue for easy pre-fixation.



The tesa® Power.Kit glue is based on modified polymer. It requires a high amount of humidity for its chemical hardening process, which means it is a very good fit for surfaces in a washroom environment.

tesa® products prove their impressive quality day in, day out in demanding conditions and are regularly subjected to strict controls. All technical information and data above mentioned are provided to the best of our knowledge on the basis of our practical experience. They shall be considered as average values and are not appropriate for a specification. Therefore tesa SE can make no warranties, express or implied, including, but not limited to any implied warranty of merchantability or fitness for a particular purpose. The user is responsible for determining whether the tesa® product is fit for a particular purpose and suitable for the user's method of application. If you are in any doubt, our technical support staff will be glad to support you.

# HOW IT WORKS

## Using tesa® Power.Kit

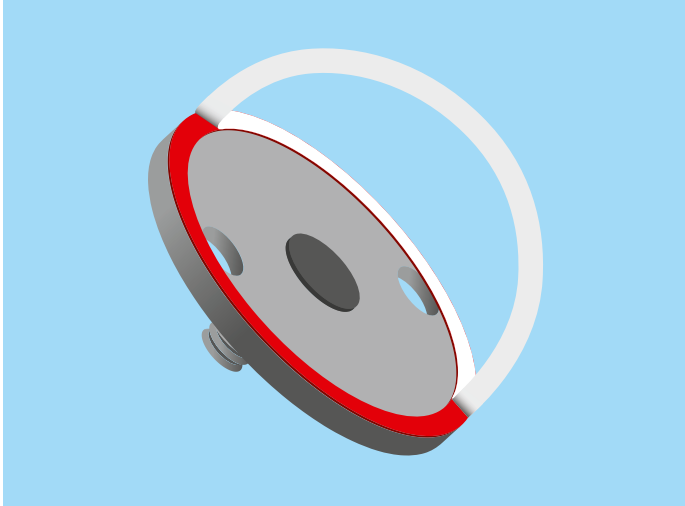

### Easy positioning

Thanks to the self-adhesive tesa® ACX<sup>plus</sup> ring the positioning of the dispenser is as easy as ABC. First clean the surface, ideally with an alcohol cleaning cloth, then remove the liner and place the adapter plate in position.

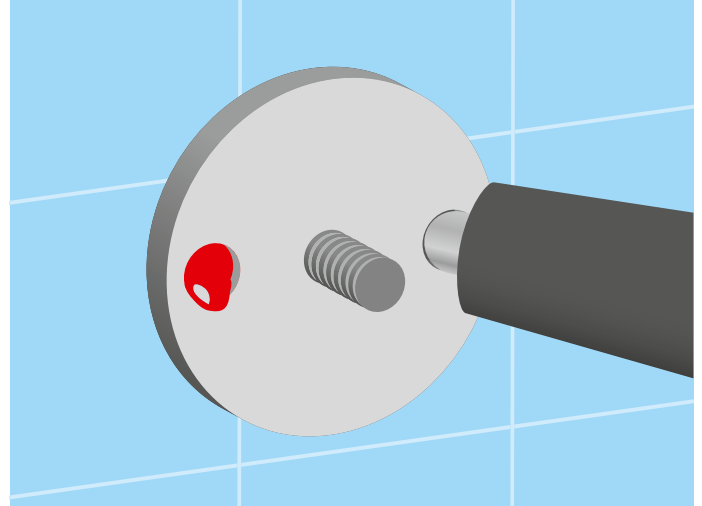

### Filling in of adhesive

Once put in place, the tesa® Power.Kit adapter can then be filled in with the liquid adhesive via the filling hole. When the adhesive comes out of the second hole the filling is complete – that's it.



### Installation of dispenser

Immediately after the adhesive has been filled into the tesa® Power.Kit adapter, the mounting plate of the dispenser can be fastened, using either screws or nuts, depending on whether you are using a male or female tesa® Power.Kit adapter. The tesa® ACX<sup>plus</sup> ring ensures sufficient adhesion until the adhesive is completely dry.

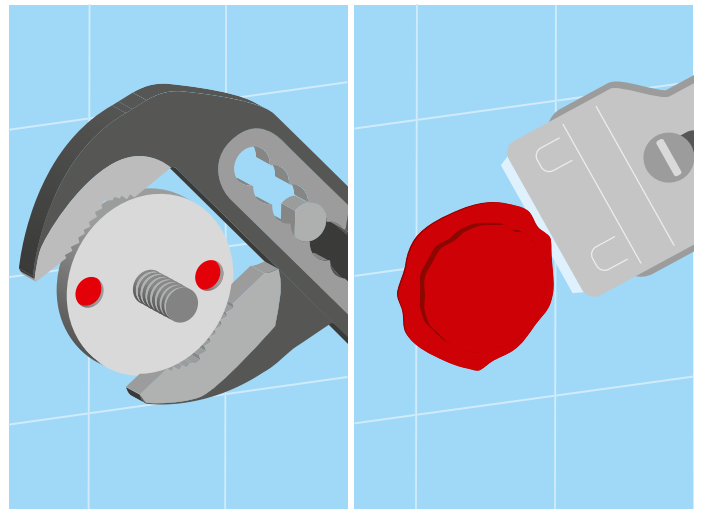

### Removal of adapter and cleaning

The tesa® Power.Kit adapter can easily be removed with a standard pipe wrench. The remaining white adhesive can best be removed from the mounting surface using a scraper and a cleaning sponge.



05/2019



Our management system is certified according to the standards ISO 9001, IATF 16949, and ISO 14001.