

The background of the advertisement shows two men in a factory or industrial setting. The man on the left is wearing a light blue button-down shirt and has a beard. The man on the right is wearing a blue polo shirt, glasses, and is smiling. They are both looking at a roll of pink and white striped tape. The man on the right is holding a large sheet of white material with a pink stripe, which is part of a larger roll of film or tape. The setting appears to be a film processing or manufacturing plant, with various pieces of equipment visible in the background.

# Specialty tapes for film converting

A complete range of splicing tapes and auxiliary assortments for maximized process efficiency at film converters

# Our value proposition – your benefits



## Partnering to solve industry challenges

Our dedicated team of more than 100 sales experts worldwide can help you improve overall efficiency by recommending solutions that optimize your existing set-ups. We are also happy to discuss specific product or testing needs whenever required and continuously strive to shape a business relationship of trust and reliability.



## Extensive R&D and lab support

Worldwide, we have 500 specialized R&D engineers transforming innovative ideas into new products and improving existing solutions. Customer needs, industry trends, as well as process and raw material innovations form the basis for our daily work to develop state-of-the-art solutions for the film producing, printing, and converting industries.

## Global presence

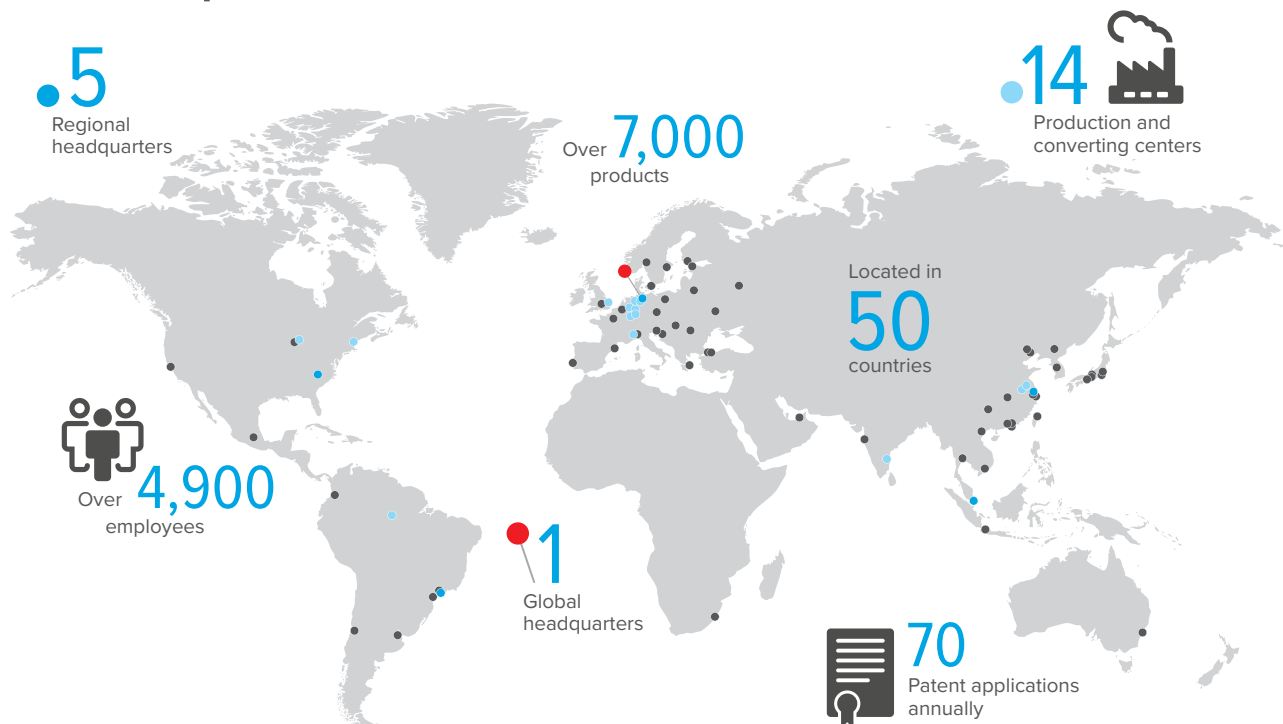

tesa® products prove their impressive quality day in, day out in demanding conditions and are regularly subjected to strict controls. All technical information and data above mentioned are provided to the best of our knowledge on the basis of our practical experience. They shall be considered as average values and are not appropriate for a specification. Therefore tesa SE can make no warranties, express or implied, including, but not limited to any implied warranty of merchantability or fitness for a particular purpose. The user is responsible for determining whether the tesa® product is fit for a particular purpose and suitable for the user's method of application. If you are in any doubt, our technical support staff will be glad to support you.



# Expertise by your side

Increasing demands on product quality and production efficiency as well as a market need for a wide range of different film materials call for a reliable partner for film converting processes. With over 125 years of experience as a global supplier of adhesive solutions and as the inventors of tesa® EasySplice for integrated flying splices, we are your reliable partner for film converting excellence.

# tesa® EasySplice FilmLine

With the invention of tesa® EasySplice, we revolutionized paper production and converting industry processes. Reliable splicing at the highest speeds combined with easy and fast job preparation was made possible, resulting in maximized process efficiency. Our tesa® EasySplice FilmLine assortment is specifically developed for film converters. The combination of tailored contact adhesives, reliable splitting strip solutions, and distinct product backings provides outstanding splice performance even on critical non-polar film materials.

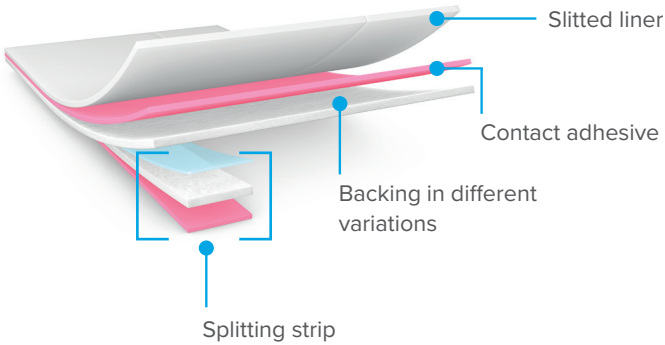

### Fast and easy preparation

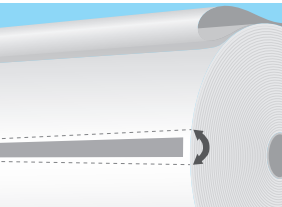

**Underneath**  
Apply the tape under the top layer of the film reel. Then remove the upper part of the liner.

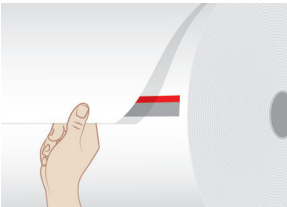

**On top**  
Attach the top layer onto the exposed adhesive of the tape.

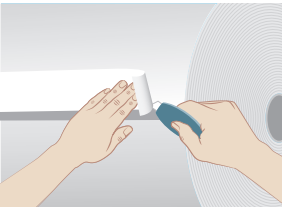

**Remove**  
Tear off the excess film following the line of the remaining section of the liner.

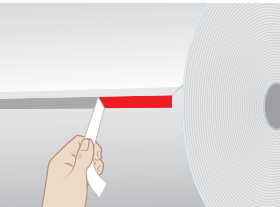

**Finish**  
Before accelerating the reel carefully remove the lower part of the liner.



**Save time**  
For reel preparation, apply just one straight line of tape – no extra tape, no additional split labels necessary.



**Accelerate production**  
Run even difficult-to-splice substrates at full machine speed.



**Reduce waste**  
Higher splice performance means less waste! tesa® EasySplice FilmLine products ensure safe closure of the reel during acceleration and precise opening after contact.

# tesa® EasySplice FilmLine assortment



Product	tesa® EasySplice 51910 FilmLine PLUS	tesa® EasySplice 51918 FilmLine Black S	tesa® EasySplice 51948 FilmLine Black X	tesa® EasySplice 61958 FilmLine Black A
Main product features	<ul style="list-style-type: none"><li>• High tack contact adhesive</li><li>• Paper backing</li></ul>	<ul style="list-style-type: none"><li>• High tack contact adhesive</li><li>• Black PET backing</li><li>• Improved wetting properties</li></ul>	<ul style="list-style-type: none"><li>• Very high tack contact adhesive</li><li>• Black PET backing</li><li>• Excellent wetting properties</li></ul>	<ul style="list-style-type: none"><li>• High tack contact adhesive</li><li>• Black PET backing</li><li>• Adhesion strip technology</li></ul>
Customer benefits	<ul style="list-style-type: none"><li>• Secure splice performance even at high speeds on:<ul style="list-style-type: none"><li>- Standard non-polar films</li></ul></li><li>• No need for scissors or cutters</li></ul>	<ul style="list-style-type: none"><li>• Secure splice performance on:<ul style="list-style-type: none"><li>- Thick films</li><li>- Sharp edge films</li><li>- Tubular bags</li></ul></li><li>• Easy splice detection</li></ul>	<ul style="list-style-type: none"><li>• Secure splice performance even at high speeds on:<ul style="list-style-type: none"><li>- High slip films</li><li>- Non-woven materials</li><li>- Recycled film materials</li></ul></li><li>• Easy splice detection</li></ul>	<ul style="list-style-type: none"><li>• Secure splice performance on standard films</li><li>• Easy splice detection</li><li>• Less waste - no splitting mechanism</li></ul>
Backing	Paper	PET	PET	PET
Color				
Tack				
Thickness w/o liner [µm/mil]	115/4.5	105/4.1	110/4.3	105/4.1
Adhesion				
Shear resistance				
Hand tearable	Yes	No	No	No
Tensile strength [N/cm]	30	70	70	70

# Conventional splicing tapes

Application	Flying splice	Flying splice	Static splice	Flying splice/ Static splice	Static splice	Static splice	Static splice	Splitting labels	Aluminum detection labels	Black detection labels
Product	tesa® 51904	tesa® 50948	tesa® 64620	tesa® 4200	tesa® 61127*	tesa® 4137	tesa® 4985	tesa® 54242*	tesa® 51003*	tesa® 51005*
Tape description	Double-sided tape	Double-sided tape	Double-sided tape	Double-sided tape	Single-sided tape	Single-sided tape	Transfer tape	Single-sided die cut	Aluminum label for inductive detection	Black label for optical detection
Main product features	<ul style="list-style-type: none"><li>• Paper backing</li><li>• High tack synthetic rubber adhesive</li><li>• Pink color</li></ul>	<ul style="list-style-type: none"><li>• Very high tack adhesive</li><li>• Black PET Backing</li></ul>	<ul style="list-style-type: none"><li>• PP backing</li><li>• High tack solvent-free adhesive</li><li>• White color</li></ul>	<ul style="list-style-type: none"><li>• PET Backing</li><li>• High tack silicone adhesive</li><li>• High temperature resistance</li><li>• Red color</li></ul>	<ul style="list-style-type: none"><li>• PET Backing</li><li>• High tack silicone adhesive</li><li>• High temperature resistance</li><li>• Black color</li></ul>	<ul style="list-style-type: none"><li>• Metalized backing</li><li>• High shear strength</li><li>• High temperature and ageing resistance</li></ul>	<ul style="list-style-type: none"><li>• Modified acrylic adhesive</li><li>• High temperature resistance</li><li>• Transparent</li></ul>	<ul style="list-style-type: none"><li>• High adhesion on various film materials</li><li>• Perforated breaking point</li><li>• Die cut on roll</li></ul>	<ul style="list-style-type: none"><li>• Aluminized paper backing</li><li>• Die cut on roll</li></ul>	<ul style="list-style-type: none"><li>• Black paper backing</li><li>• Die cut on roll</li></ul>
Customer benefits	<ul style="list-style-type: none"><li>• Secure splice performance on standard non-polar substrates, even at high speeds</li><li>• No need for scissors or cutters</li><li>• Easy splice detection</li></ul>	<ul style="list-style-type: none"><li>• Secure splice performance on:<ul style="list-style-type: none"><li>- High slip films</li><li>- Non-woven materials</li><li>- Recycled film materials</li></ul></li><li>• Easy splice detection</li></ul>	<ul style="list-style-type: none"><li>• Secure splice performance on standard films and at low speeds</li></ul>	<ul style="list-style-type: none"><li>• Best splice performance on various siliconized substrates even at high speeds</li><li>• Easy splice detection</li></ul>	<ul style="list-style-type: none"><li>• Best splice performance on various siliconized substrates even at high speeds</li><li>• Easy splice detection</li></ul>	<ul style="list-style-type: none"><li>• Easy splice detection by light and heat radiation</li></ul>	<ul style="list-style-type: none"><li>• Easy automatic application</li><li>• Excellent conformability on substrate</li></ul>	<ul style="list-style-type: none"><li>• Easy top sheet fixation for conventional flying splice</li></ul>	<ul style="list-style-type: none"><li>• Easy splice detection</li></ul>	<ul style="list-style-type: none"><li>• Easy splice detection</li></ul>

# Complementary tapes

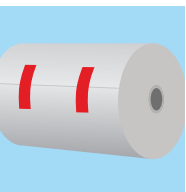

	Tape description	Thickness [µm/mil]	Adhesive	Backing	Color
End tabbing					
tesa® 4124	Single-sided tape	65/2.6	Natural rubber	PVC	
tesa® 60404	Colored single-sided tape	67/2.6	Natural rubber	PVC	

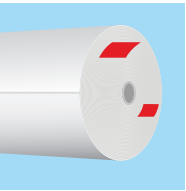

Failure flagging					
tesa® 60404	Colored single-sided tape	67/2.6	Natural rubber	PVC	

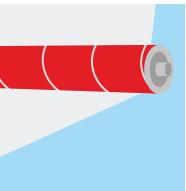

Roller wrapping and belting					
tesa® Printer's Friend 4863	Embossed surface	620/24.4	Natural rubber	Silicone-coated cloth	
tesa® Printer's Friend 4563	Smooth surface	380/15	Natural rubber	Silicone-coated cloth	
tesa® 4820*	Single-sided PTFE tape	100/3.9	Silicone	PTFE	
tesa® 4830	Single-sided PTFE tape	160/6.3	Silicone	PTFE	

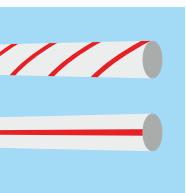

Core starting					
tesa® 51194	Splittable double-sided tape	120/4.7	Synthetic rubber	Splittable paper	
tesa® 60404	Colored single-sided tape	67/2.6	Natural rubber	PVC	
tesa® 64620	Double-sided tape	185/7.3	Synthetic rubber	PP	
tesa® 52307*	Double-sided tape	70/2.8	Acrylic	PVC	
tesa® 51904	Double-sided tape	110/4.3	Synthetic rubber	Non-woven	
tesa® 4985	Transfer tape	50/2	Acrylic	None	

\* Available upon request. Please contact your local sales representative for more information



## Certifications

Our company is focused on international quality, environmental, and occupational safety standards.

Please find more information regarding our certifications at:  
**[www.tesa.com/certifications](http://www.tesa.com/certifications)**

### United States and Canada

tesa tape, inc.

5825 Carnegie Boulevard • Charlotte, NC 28209

Phone: +1-800-426-2181

Email: [customercare@tesatape.com](mailto:customercare@tesatape.com)

**[tesatape.com](http://tesatape.com)**