



Complete package for high-quality label printing

tesa® self-adhesive tape assortment
for flexographic label printing

Comprehensive offering

Success in the label and package printing industry requires know-how, experience, and a well-balance of process parameters and materials. As a leading global manufacturer of adhesive solutions, we offer a wide range of specially developed tapes to meet the requirements within your production environment.

Plate mounting tapes for your individual requirements

Plate mounting tapes have a critical influence on your process efficiency and print quality. Our tesa® Softprint assortment is supported by our smart tape production process – leaving all foam cells within the tape backing intact for better cushioning and resilience over time. Selecting the correct foam hardness from our assortment will produce exceptional print quality by increasing your printing speed and overcoming print defects like banding, increased dot gain, and “pin holing”.

tesa® Softprint 15 mil category*

X-Soft	Soft	Medium	Medium-Hard	Hard	Product color code
					Print motif

Classic product design

Product	tesa® 52018	tesa® 52017	tesa® 52016	tesa® 52015	tesa® 52014	Description
tesa® Softprint STM						High tack adhesive for plate mounting in unclean and cold conditions. Secure bonding with excellent resistance to edge lifting.
tesa® Softprint TP	tesa® 52118	tesa® 52117	tesa® 52116	tesa® 52115	tesa® 52114	Medium tack adhesive for reliable plate mounting under most conditions. Secure bonding with excellent resistance to edge lifting.
tesa® Softprint SEC	tesa® 52818	tesa® 52817	tesa® 52816	tesa® 52815	tesa® 52814	Low tack adhesive for easy and fast plate mounting in clean and standardized conditions. Secure bonding with excellent resistance to edge lifting.

Flex product design

Product	tesa® 53418	tesa® 53417	tesa® 53416	tesa® 53415	tesa® 53414	Description
tesa® Softprint FE						Compensating product design for demanding sleeve/cylinder surfaces. Very low tack adhesive for easy and fast plate mounting in clean and standardized conditions. Secure bonding with excellent resistance to edge lifting.

*also available: tesa® Softprint 20 mil category

Steps for optimal plate mounting

Cleaning	Mounting	Demounting
 Plate cleaning	 Tape mounting	 Plate demounting
 Cylinder/sleeve cleaning	 Plate mounting	 Tape demounting

Our complementary products for flexographic printing

	Special feature	Thickness [µm/mil]	Adhesive	Backing	Color
Splicing					
tesa® 51904	d/s tape with high tack, high adhesion for flying splice	110/4	Synthetic rubber	Non-woven	
tesa® 64620	d/s tape with low tack, medium adhesion for flying splice	185/7	Synthetic rubber	PP	
tesa® 60404	s/s tape for butt splicing	67/3	Natural rubber	PVC	
tesa® 4122	s/s tape with high tear strength for butt splicing	88/3	Natural rubber	PVC	
tesa® 4137	s/s tape for butt splicing and inductive detection	50/2	Acrylic	PET	
Roller wrapping					
tesa® Printer's Friend 4863	Embossed surface	620/24	Natural rubber	Cloth	
tesa® Printer's Friend 4563	Smooth surface	380/15	Natural rubber	Cloth	
Edge sealing					
tesa® 4174	Flexible s/s tape	110/4	Natural rubber	PVC	
tesa® 60404	Rigid s/s tape	67/3	Natural rubber	PVC	
Core starting					
tesa® 60404	s/s tape for safe bonding on paper and PE cores	67/3	Natural rubber	PVC	
tesa® 51194*	Splittable d/s tape for flying splice labelling applications	120/5	Synthetic rubber/acrylic	Splittable paper	
Failure flagging					
tesa® 60404	Different colors to mark material imperfections	67/3	Natural rubber	PVC	
End tabbing					
tesa® 60404	Safe bonding on all kind of materials	67/3	Natural rubber	PVC	
Additional tools					
tesa® 52064	Plate cleaning				
tesa® 52065	Rubber roller				
tesa® 60111	Adhesion promoter				

*Dispensers are available

Tape applications for your production process

During label and packaging printing many different parameters have an influence on the quality of the end product. With our high quality process tapes we supply the best possible solution to be successful in producing your required level of quality. Our broad assortment is developed based on your individual needs.

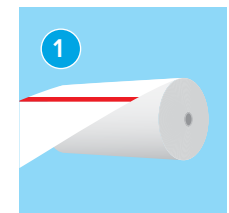

Splicing

To splice different label stock or other packaging materials we offer a comprehensive assortment of double-sided and single-sided splicing tapes.

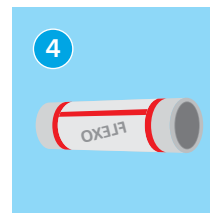

Edge sealing

Specific circumstances like older stiff plates or small cylinder diameters may require additional support against plate edge lifting.

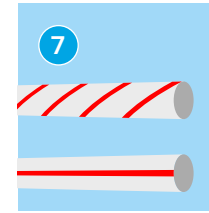

Core starting

For rough core surfaces, we provide several tapes with excellent adhesion properties to ensure the web is securely attached to the core.

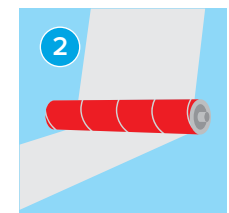

Roller wrapping

tesa® Printer's friend tapes offer outstanding grip to process high-slip materials and repel a variety of substances involved in the process (e.g. adhesives and inks).



Adhesion promoter

For additional bonding strength to plate edge if needed.

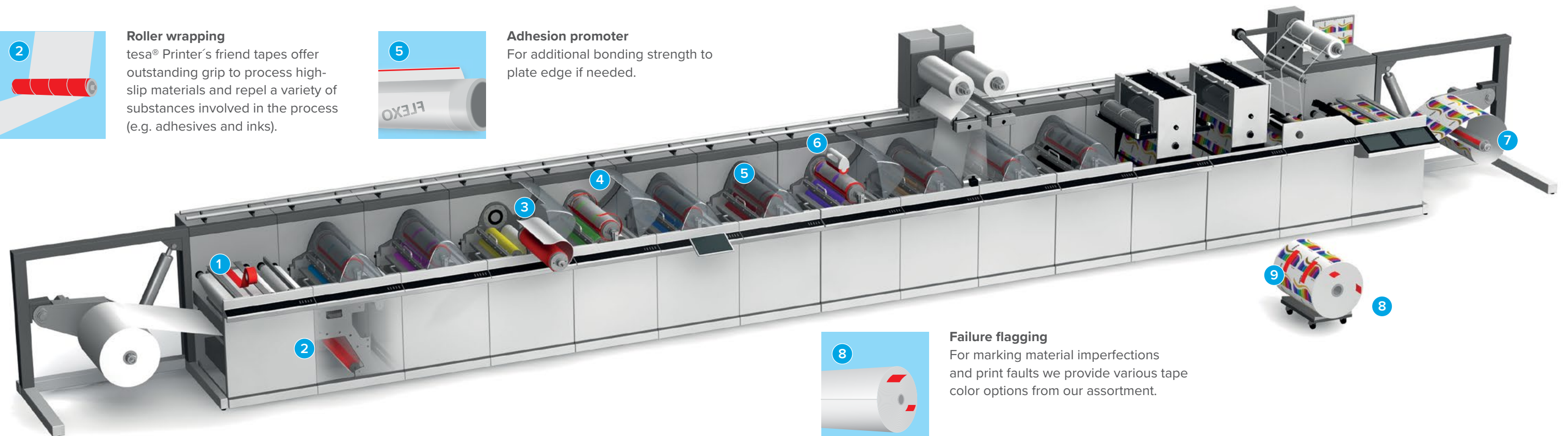
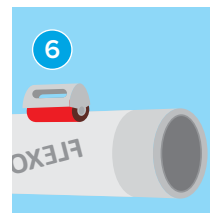

Plate mounting

Increasing demands on print quality and process efficiency call for specifically tailored plate mounting tapes. Our tesa® Softprint assortment provides distinctive product lines for flexo printers to fulfill each and every requirement.



Supportive tools

We also offer supportive tools such as cleaning rollers and rubber rollers to make several process steps easier and more efficient.

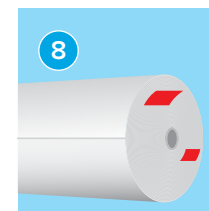

Failure flagging

For marking material imperfections and print faults we provide various tape color options from our assortment.

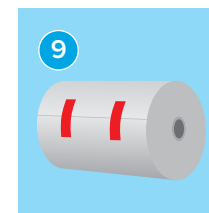

End tabbing

To close converted reels for storage or later processing. Our tapes offer safe bonding on various substrates.



tesa® products prove their impressive quality day in, day out in demanding conditions and are regularly subjected to strict controls. All technical information and data above mentioned are provided to the best of our knowledge on the basis of our practical experience. They shall be considered as average values and are not appropriate for a specification. Therefore tesa SE can make no warranties, express or implied, including, but not limited to any implied warranty of merchantability or fitness for a particular purpose. The user is responsible for determining whether the tesa® product is fit for a particular purpose and suitable for the user's method of application. If you are in any doubt, our technical support staff will be glad to support you.



Consult our online
Foam Advisor for plate
related foam advice.
www.tesa.com/foamadvisor



02/2025

Certifications

Our company is focused on international quality, environmental, and occupational safety standards.

Please find more information regarding our certifications at:
www.tesa.com/certifications

United States and Canada

tesa tape, inc.

25 Ottawa Ave. SW Suite 500 • Grand Rapids, MI 49503

Phone: 1-800-426-2181 • Email: marketing.na@tesa.com

ISO 9001:2008 Certified • ISO/TS 16949:2009 Certified • ISO 14001:2004 Certified + Cor 1:2009 Certified



© tesa tape, inc. 02-2025