

APPLICATION GUIDE

Structural Glazing

External Factors



- When transporting and storing adhesive tapes ensure they do not come in contact with dirt, dust, grease, oil, moisture or other contaminants.
- When transporting and storing tesa® ACX^{plus}, all slit edges should be covered with suitable separators made of siliconized film. If several rolls are stacked two sheets per roll should be used.



- The recommended application temperature is between 15°C and 35°C.



- Appropriate cleaning solvents are acetone, 100% isopropyl alcohol, or our tesa® Industry Cleaner 60040.
- Use a lint-free cloth to clean the surface.

Tips & Tricks



- Avoid direct skin contact with the cleaning solvents and adhesion promoter – wear gloves.



- The workplace must be free of dirt, dust, grease, oil, moisture and other contaminants.



- Possible application tools for the tesa® Adhesion Promoter are a melamine sponge, application pen or a lint-free cloth.
- All of our adhesion promoters can be applied using the tools above with the exception of tesa® 60151 Adhesion Promoter Glass. For this adhesion promoter we always recommend using a lint-free cloth.

Please contact your local tesa sales representative for more specific information about your application process.

Application Guide – Structural Glazing

Process Steps



1 Clean glass in one direction with appropriate solvents using a lint-free cloth. Allow solvent to evaporate.



2 Shake the tesa® 60151 Adhesion Promoter Glass bottle before opening. Apply the promoter and immediately remove excess promoter with dry cloth (two cloth technique). Always close the bottle after usage.

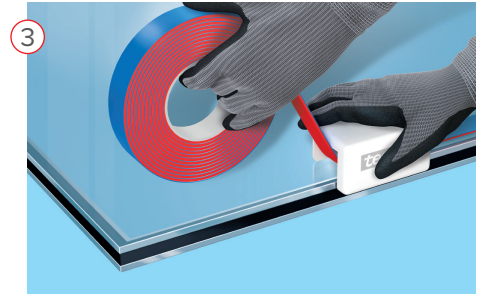

3 Apply tesa® ACX^{plus} onto glass.

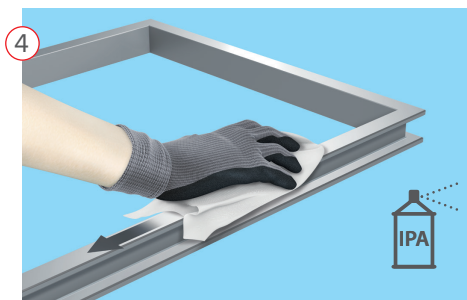

4 Clean frame in one direction with appropriate solvents using a lint free cloth. Allow solvents to evaporate.

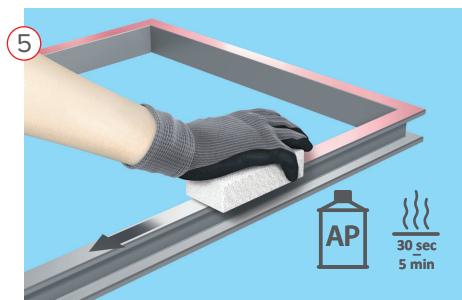

5 Shake the tesa® Adhesion Promoter can before opening. Apply tesa® Adhesion Promoter with a tool. Allow solvents to evaporate. Always close the can after usage.

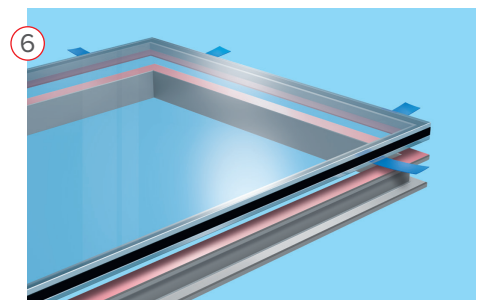

6 Remove liner at the edges.

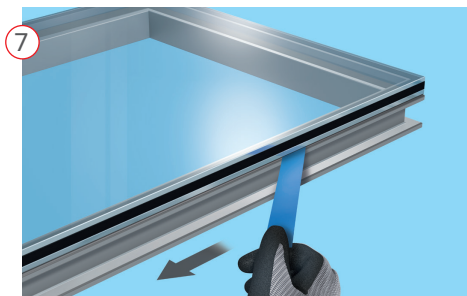

7 Position glass on frame and pull liner out.

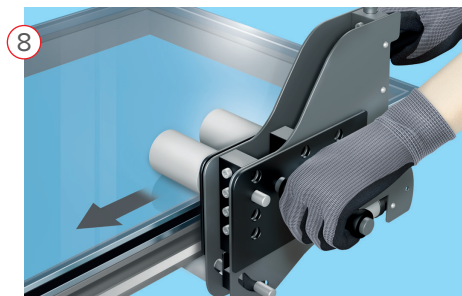

8 Apply sufficient pressure using a tool.