

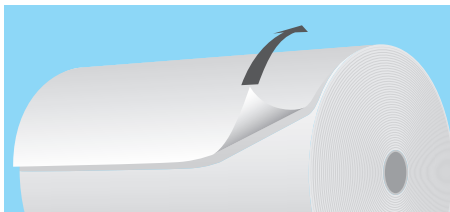

APPLICATION GUIDE

tesa EasySplice® for the Paper Printing Industry



1. Fold back top layer.

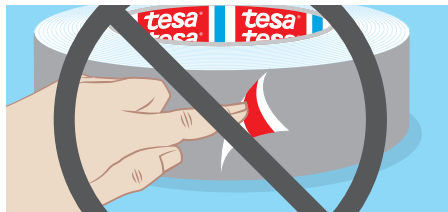

2. Do not touch the exposed adhesive area on the reverse side of the tape.

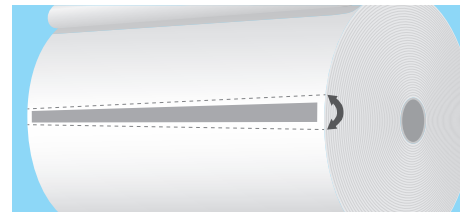

3. Apply the tape in a straight line or at a slight angle (narrow part of liner on top).

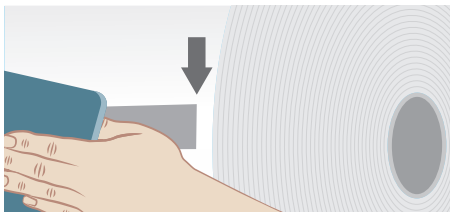

4. Leave a space of 10 mm (~0.5") on either side of the reel. Apply pressure on the tape to ensure excellent adhesion.

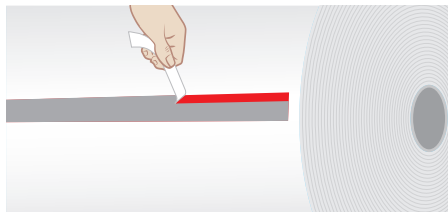

5. Remove the narrow part of the liner, pulling upwards.

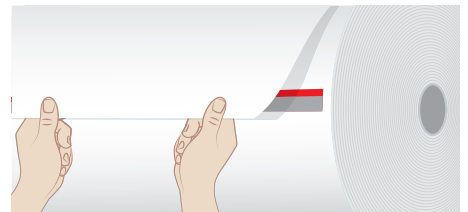

6. Pull the top sheet tightly over the exposed adhesive.



7. Fold back the excess material.

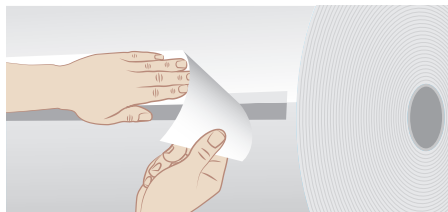

8. Tear away the excess material.

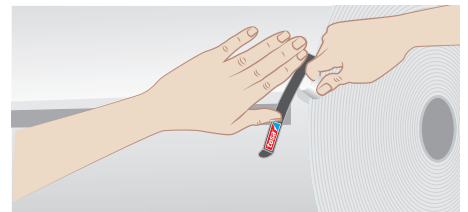

9. Trim both edges.

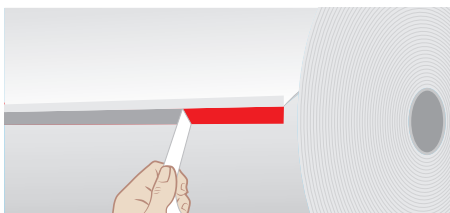

10. Remove the remaining liner, pulling downwards.

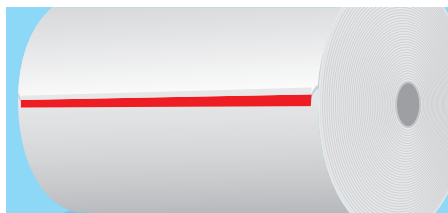

11. Reel is ready to splice.

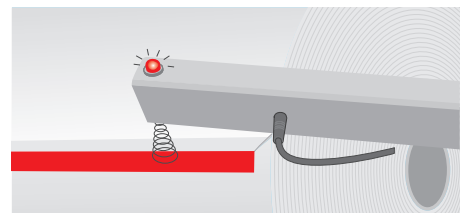

12. Reliable splice identification with tapes that include detection features.